

THIS DRAWING IS UNPUBLISHED. RELEASED FOR PUBLICATION, 19 .  
 © COPYRIGHT 19 BY AMP INCORPORATED. ALL INTERNATIONAL RIGHTS RESERVED.

| LOC | DIST | P | F | ZONE | LTR | DESCRIPTION             | DATE      | APPD |
|-----|------|---|---|------|-----|-------------------------|-----------|------|
| GP  | 00   |   |   |      |     |                         |           |      |
|     |      |   |   |      | H   | REV PER 0U1D-0274-00    | 22 OCT 01 | JR   |
|     |      |   |   |      | J   | REV PER EC 0UE0-0002-01 | 10 JAN 02 | JR   |

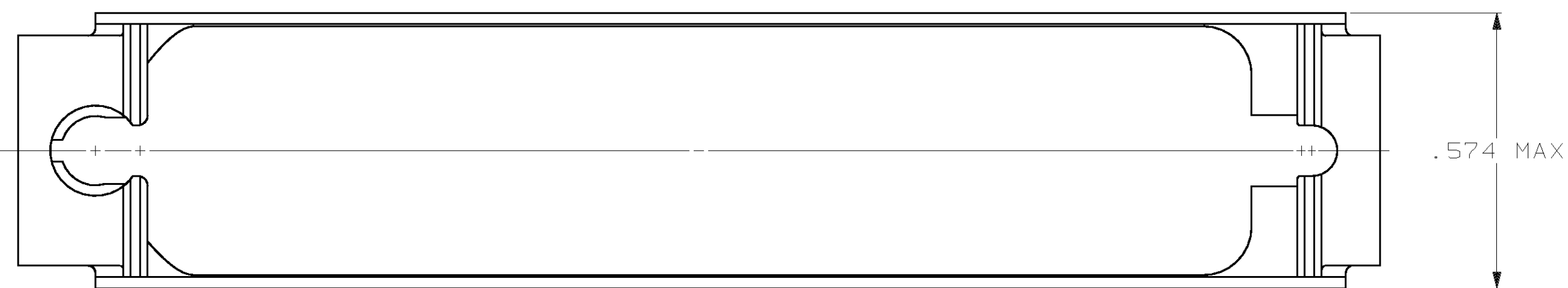
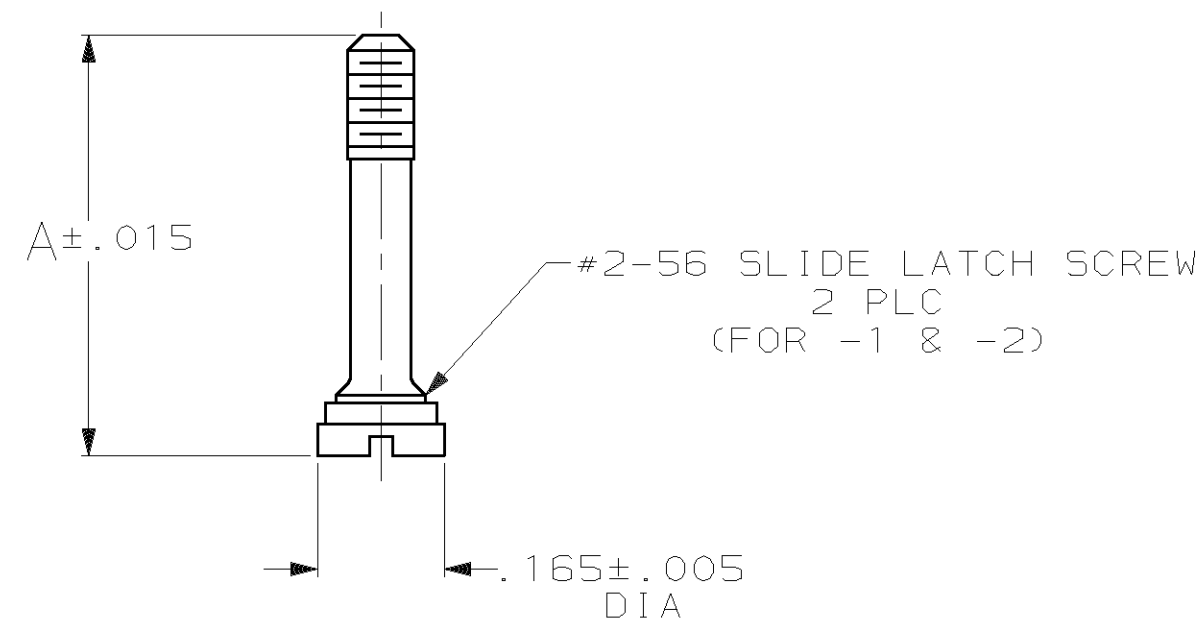
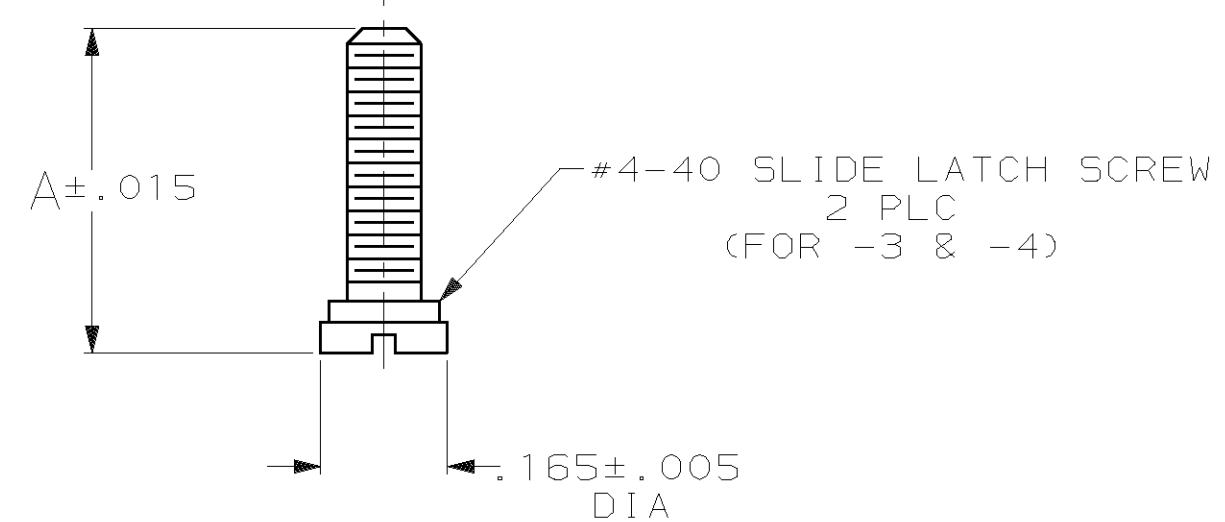
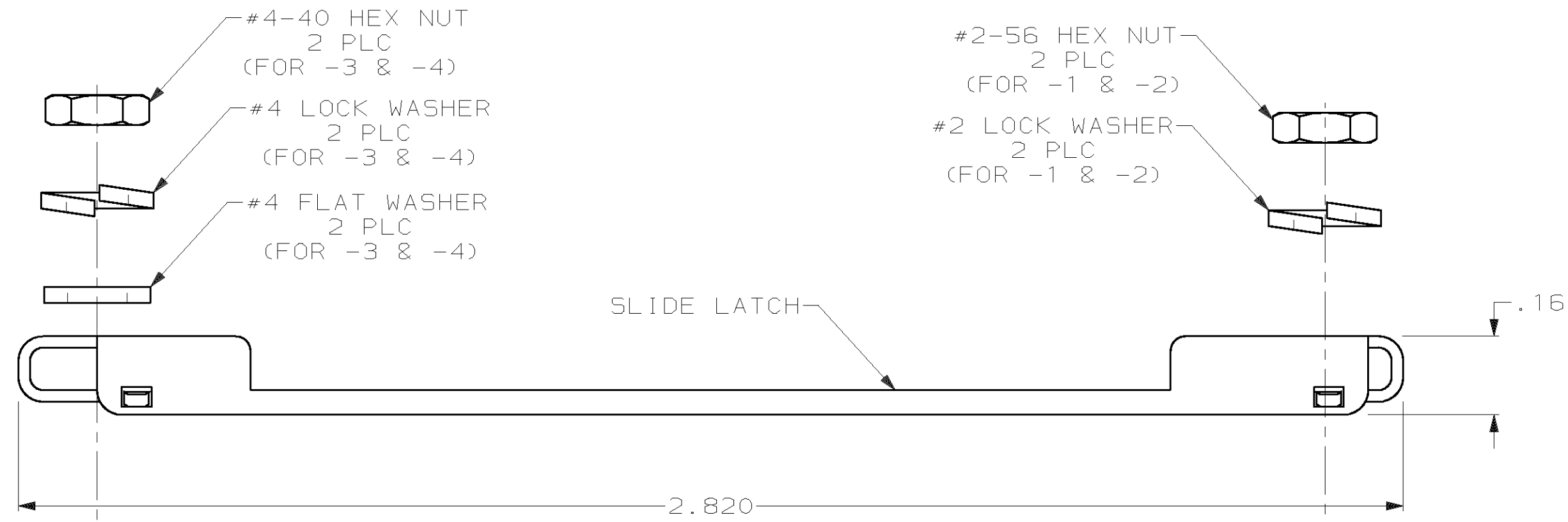

|    |                        |      |    |       |    |          |
|----|------------------------|------|----|-------|----|----------|
| △7 | SUPERSEDED BY 745578-3 | .415 | △5 | #4-40 | △3 | 745578-4 |
| △7 |                        | .415 | △5 | #4-40 | △2 | 745578-3 |
| △6 | OBSOLETE               | .547 | △4 | #2-56 | △3 | 745578-2 |
| △6 | OBSOLETE               | .547 | △4 | #2-56 | △2 | 745578-1 |

1. PARTS PACKAGED UNASSEMBLED.
- △2 PARTS PACKAGED AS A UNIT KIT.
- △3 PARTS INDIVIDUALLY BULK PACKAGED & SHIPPED AS A UNIT PACKAGE.
- △4 ZINC PLATED PER ASTM B633, TYPE III, CLASS SC1, CLEAR CHROMATE.
- △5 ZINC PLATED PER ASTM B633, TYPE II, CLASS SC1, YELLOW CHROMATE.
- △6 THIS KIT CAN BE USED WITH TWO-PIECE STRAIGHT/90° EXIT CABLE CLAMPS, RFI/EMI CABLE CLAMPS OR UNIVERSAL CABLE CLAMPS.
- △7 THIS KIT CAN BE USED WITH STRAIGHT/45° EXIT ONE-PIECE CABLE CLAMPS, STRAIGHT/90° EXIT ONE-PIECE CABLE CLAMPS, OR ON CONNECTORS WITHOUT CABLE CLAMPS.

| DO NOT SCALE PRINT. UNLESS SPECIFIED DIMENSIONS IN INCHES TOLERANCES ON: |        | DR      | CHK      | APPD    | APPD      | PRODUCT SPEC | APPLICATION SPEC | WEIGHT | SIZE  | FSCM NO | DRAWING NO |
|--|--------|---------|----------|---------|-----------|--------------|------------------|--------|-------|---------|------------|
| 2 PLC DEC  | ± -    | 8-12-88 | 8-12-88  | 8-15-88 | 8-16-88   | -            | -                | -      | C     | 00779   | 745578     |
| 3 PLC DEC  | ± .010 | L SIPE  | W LENKER | R WHYNE | J SHOWERS | -            | -                | -      | SCALE | 4:1     | SHEET      |
| ANGLES   | ± -    |         |          |         |           |              |                  |        |       |         | 1 OF 1     |
| MATERIAL   |        |         |          |         |           |              |                  |        |       |         |            |
| SLIDE LATCH: STAINLESS STEEL   |        |         |          |         |           |              |                  |        |       |         |            |
| HARDWARE: STEEL PER ASTM A108  |        |         |          |         |           |              |                  |        |       |         |            |
| FINISH   |        |         |          |         |           |              |                  |        |       |         |            |
| HARDWARE: SEE TABLE  |        |         |          |         |           |              |                  |        |       |         |            |

**AMP** | AMP INCORPORATED  
Harrisburg, Pa. 17105

NAME  
KIT, SLIDE LATCH, SIZE 5,  
50 POSITION, AMPLIMITE®

SCALE 4:1